

# Public Document Pack



**KELSO COMMON GOOD  
SUB-COMMITTEE  
TUESDAY, 27TH JUNE, 2023**

---

**Please find attached Documents in respect of Item No. 7  
on the agenda for the above meeting**

7.	<b>Pinnaclehill Park - Orchard Project</b> (Pages 3 - 10)  Consider initial enquiries regarding the possible Lease of Common Good Land. (Documents attached)	15 mins
----	--	---------

This page is intentionally left blank

## Pinnaclehill Park Orchard

### Back Ground

A group of residents within Pinnaclehill Park would like to develop the small area of Common Good land currently designated as the “play area”. The land is currently grass which is cut twice a year, with no play equipment (never has been any), with a path at one edge which gives access to the riverside walk (map of land below). The purpose of the project is to turn the current space into a community orchard with a strong emphasis on increasing the use of the space and the biodiversity of the site. Benches would also provide a space for residents to meet and interact with each other.

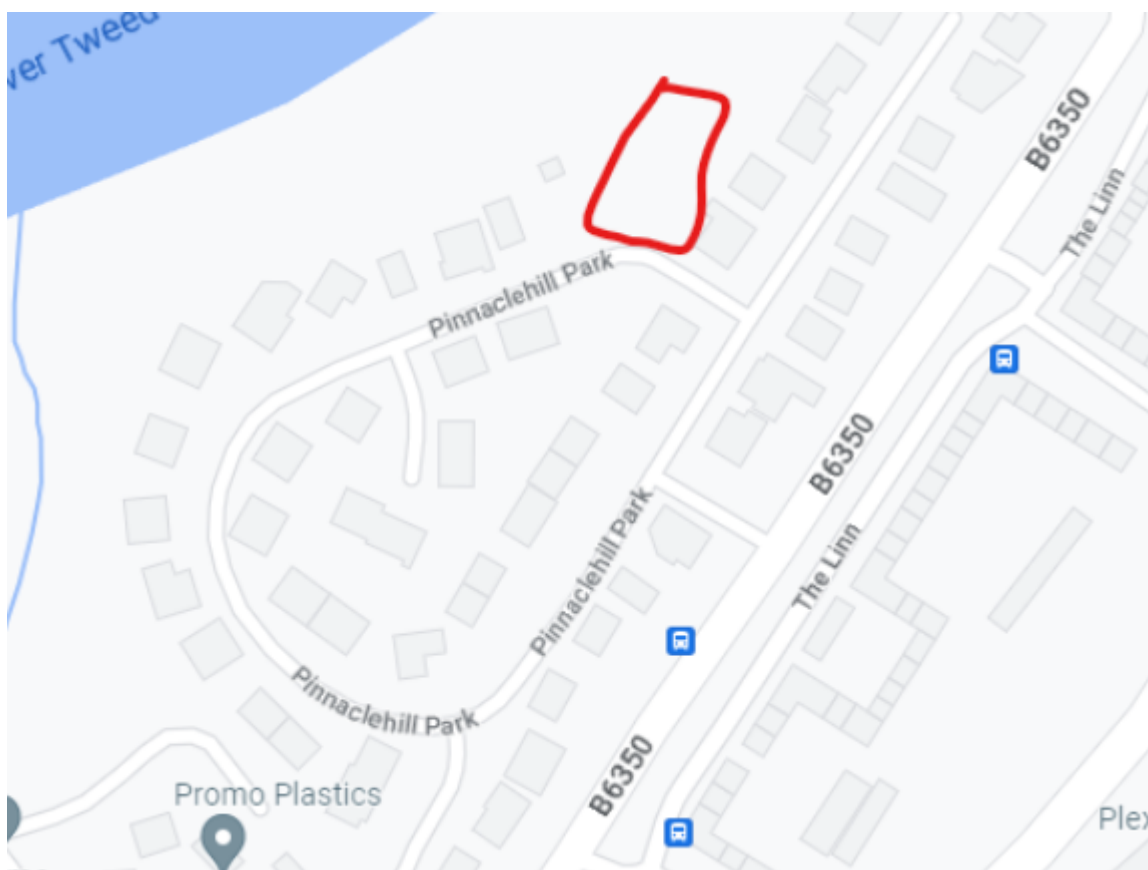

### Step so far

Engagement has been undertaken over the last couple of months with the following individuals and groups.

- Emma Husband – Community Engagement Officer – to identify other local groups and possible funding sources.
- Amy Alcorn – Greenspace Programme Officer - to check the proposals fitted with the Council’s objectives, discuss options, and find out how similar projects/groups work. Also, for ideas on how to engage with residents to promote the project.
- Residents – a open meeting was held on site, on Saturday 10<sup>th</sup> June, with invites to every household with Pinnaclehill Park to discuss the idea and gain an understanding of the level of interest or concerns of the scheme. The

meeting was attended by 8 households and emails/notes of support from a further 7 households within the scheme. Possible plans and ideas were discussed and volunteers gained to help take the project and group forward. All residents who directly back onto the land have been consulted and all are fully supportive.

The draft plans and information discussed at the meetings are attached for information.

### **Next Steps**

To enable the project to progress the following next steps will be completed:

1. Apply to Kelso Common Good Committee for approval to use/access the land and agree legal requirements
2. Establish a formal constitution for the group and appoint office bearers
3. Submit update to Common Good Committee in Sept 2023.
4. Establish bank accounts
5. Identify possible funding options
6. Submit grant applications
7. Complete works

Before we do any further work on project we thought it would be good to understand if the Common Good Committee was agreeable to the principal of the idea subject to legal and funding considerations.

# **PINNACLEHILL PARK ORCHARD PROJECT**

## **Objective**

To turn the parcel of land behind 48,49,50 Pinnaclehill Park, currently designated as a dog walking area, into an organic community orchard and wildflower area.

## **Introduction**

SBC Parks and Environment department, recognizing the need to reduce costs, reduce carbon emissions, increase biodiversity and encourage local, stable food sources, is keen to consider community projects to repurpose under-utilised areas to meet these needs.

The plot of land in question is Common Good land, a great fit with his initiative and has the potential to become an inclusive, green, multi-functional space for everyone in the neighbourhood.

## **Process & Timing**

1. Seek approval for the proposal
  - ✓ Discuss proposal with Councillor Mountford, Amy Alcon, Emma Husband
  - ✓ Engage Pinnaclehill Park residents
  - Present proposal to the Common Good Committee for approval. 27<sup>th</sup> June
1. Once approved:
  - Develop an application for financial assistance to the Kelso Common Good Fund
  - Pursue additional sources of funding
  - Cease mowing (except designated areas) and monitor species appearance
  - Aim to plant the first trees and hedging plants during Winter 2023/24 and plant wildflowers Spring 2024

## **Benefits to the community**

- Provide fresh, sustainable, affordable, organically grown fruit
- Get people active, improving physical and mental health
- Provide a shared purpose and build a sense of community and belonging
- Get people closer to nature, improving mental health and wellness
- A beautiful space for people of all ages and backgrounds to come together
- Encourage and share knowledge about gardening organically and in partnership with nature
- Create opportunities for involvement in citizen science projects
- Enable people to combat “eco-anxiety”, channeling it into tangible action for the environment
- Increase pollinators and therefore flower/food crops in neighbouring gardens

## Benefits to nature and the environment

- Create a species rich wildflower area, eliminating a “green desert” and providing food and habitat for insects and the food chains they support
- Provide approx. 40m of native hedging, creating food and shelter for insects and birds
- Increase biodiversity
- Produce food with zero food miles or packaging
- Reduce or eliminate the fossil fuel currently used to mow the area
- Maintain the “purity” of the land, by zero-use of chemical pesticides, herbicides and fungicides

## Funding

**Initial funding** will be needed for:

- Native Hedging Plants
- Organic fruit and nut trees
- Fruit bushes
- Native wildflower seeds/plugs
- 2+ Garden benches
- Materials for compost bins (reclaimed where possible)
- Water storage
- Solitary bee homes<sup>1</sup>

Additionally, depending on the specific use of the plot, **further funding** may be needed, for example:

- Materials for a fruit cage
- Materials for wildlife houses (bird boxes, bug hotels, hedgehog houses)
- Storage shed (including fruit storage trays)
- Tool hire to remove grass & prepare soil for seeding
- Picnic table

**Funding could be obtained** through a variety of sources, including:

- Common Good Fund
- Neighbourhood Support Fund
- Small Schemes Fund – garden benches
- Council compost scheme
- Community fund raising (e.g. plant sales, fruit sales, bake sales)
- Hedging plants from Woodland Trust: [Free Trees for Schools and Communities - Woodland Trust](#)
- Membership subscriptions

---

<sup>1</sup> Typically, about two-thirds of the pollinators that visit apple blossoms are solitary bees, mainly mason bees and mining bees” Dave Goulson, *The Jungle Garden* (Vintage, 2020) pg 59

## A LITTLE CONTEXT

### Food Miles

- According to “The Eco Experts”<sup>2</sup> in the UK, food transportation is responsible for **25% of all miles** covered by heavy goods traffic and globally, food miles generate **3 billion tonnes of carbon dioxide equivalent (CO<sub>2</sub>e)** each year. The three key actions all of us can take to reduce food miles are:
  - Shop locally
  - Eat seasonally
  - Grow your own
- 80% of UK orchards have gone since 1920 due to competition from imports<sup>3</sup>

### Biodiversity - Some Statistics

- In a 2018 study on “biodiversity intactness”, the UK ranked 189th out of 218 countries<sup>4</sup>
- Buglife study showed that UK flying insect populations have declined by over 60% in the last 20 years<sup>5</sup>
- 80% of butterfly species have declined across the UK since the 1970s, with particularly dramatic declines in habitat specialists<sup>6</sup>
- In the next few decades, as many as 40% of the world's insect species could become extinct<sup>5</sup>
- Gardens cover about half a million hectares in the UK, more than all our nature reserves<sup>7</sup> and offer excellent opportunities to create important wildlife “corridors” to reduce fragmentation.

### Causes of Insect Decline

There are multiple compounding pressures leading to these declines, including:

- Use of pesticides and fungicides
- Loss of habitat due to urbanization and conversion of meadows, woodland and hedgerows into pasture and arable land
- “Monoculture” planting
- Habitat fragmentation
- Climate change
- Air and light pollution

---

<sup>2</sup> [What Are ‘Food Miles’ And How Can You Reduce Them? | The Eco Experts](#)

<sup>3</sup> Dave Goulson, *Silent Earth* (Vintage, 2021) pg 258

<sup>4</sup> Dave Goulson, *Silent Earth* (Vintage, 2021) – pg 279

<sup>5</sup> Bug Matters Survey report, [Buglife](#)

<sup>6</sup> The State of UK’s Butterflies 2022 Report, [Butterfly Conservation](#)

<sup>7</sup> Dave Goulson, *Silent Earth* (Vintage, 2021) pg 244

## Impact of Insect Decline

The impact of insect declines is far-reaching, because of the numerous roles they play and their position in the food chain. Some impacts are noticeable already, all will become increasingly noticeable over time:

- Reduced production of food plants requiring insect pollination. This will result in a loss of “real food” such as fruits and vegetables, as well as treats such as chocolate, wine, coffee etc.
- Increase in “unwanted” insects
- Declines in animals higher up the food chain
- Reduced recycling of dead plant and animal matter

## Predator Allies for Orchards<sup>8</sup>

Species	Prey	How to attract them
Bats	Codling moth	
Earwigs*	Aphids, scale insects, codling moth	Bottle refuges
Ladybirds**	Aphids	Nettles, Yarrow, Feverfew
Hoverflies	Aphids	Small flowers, such as yarrow, lemon balm, cow parsley, sweet cicely
Ground Beetles	Sawfly larvae, moth caterpillars	Logs/large stones around base of trees
Parasitic wasps	Caterpillars, sawflies, leaf midge, aphids, ants	Yarrow, mallow, lemon balm
Lacewings	aphids	Log piles, dense hedges, yarrow, dandelion, sweet cicely, cow parsley

\* Earwigs have been estimated to eat as many aphids each year in apple orchards as could be killed by three rounds of spraying with insecticides. Unfortunately, in most commercial orchards earwigs have been eradicated by insecticides<sup>9</sup>

\*\* Ladybird larvae can munch their way through up to 5000 aphids each before pupating into an adult where their hunting resumes









<sup>8</sup> Beneficial predators to welcome to you orchard – [The Orchard Project](#)

<sup>9</sup> Dave Goulson, *The Garden Jungle* (Vintage, 2020) – pg 40)



# Possible Planting Plan 1

## with fruit cage

-  Native Wildflowers (meadow or perennials)
-  Mixed native hedging (e.g. Hawthorn, Blackthorn, Viburnum, Holly,
-  Fruit Trees
-  Rhubarb
-  Fruit bushes to share with the birds (e.g. red, white, black currants,
-  Soft Fruit cage
-  Compost bins
-  Seating/picnic table

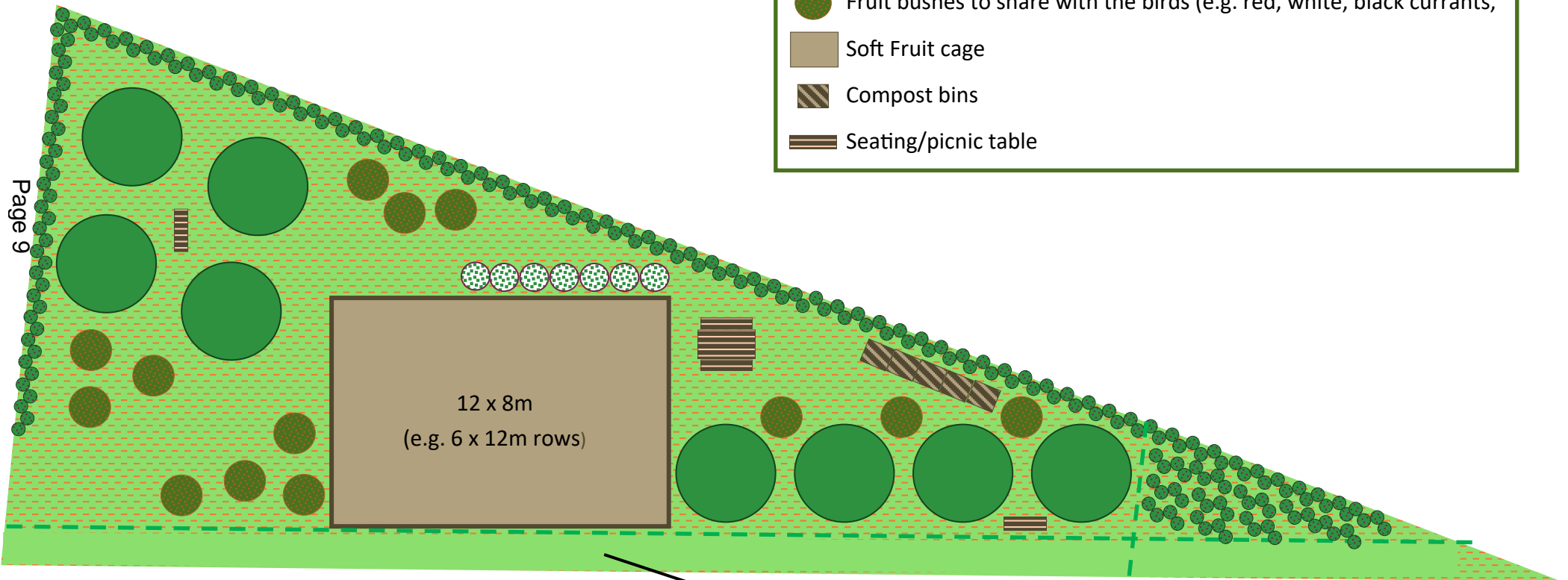









Page 9

Scale—5cm : 10m

# Possible Planting Plan 2

## Forest Gardening

-  Native Wildflowers (meadow or perennials)
-  Mixed native hedging (e.g. Hawthorn, Blackthorn, Viburnum, Holly,
-  Fruit Trees
-  Rhubarb
-  Fruit bushes to share with the birds (e.g. red, white, black currants,
-  Soft Fruit cage
-  Compost bins
-  Seating/picnic table

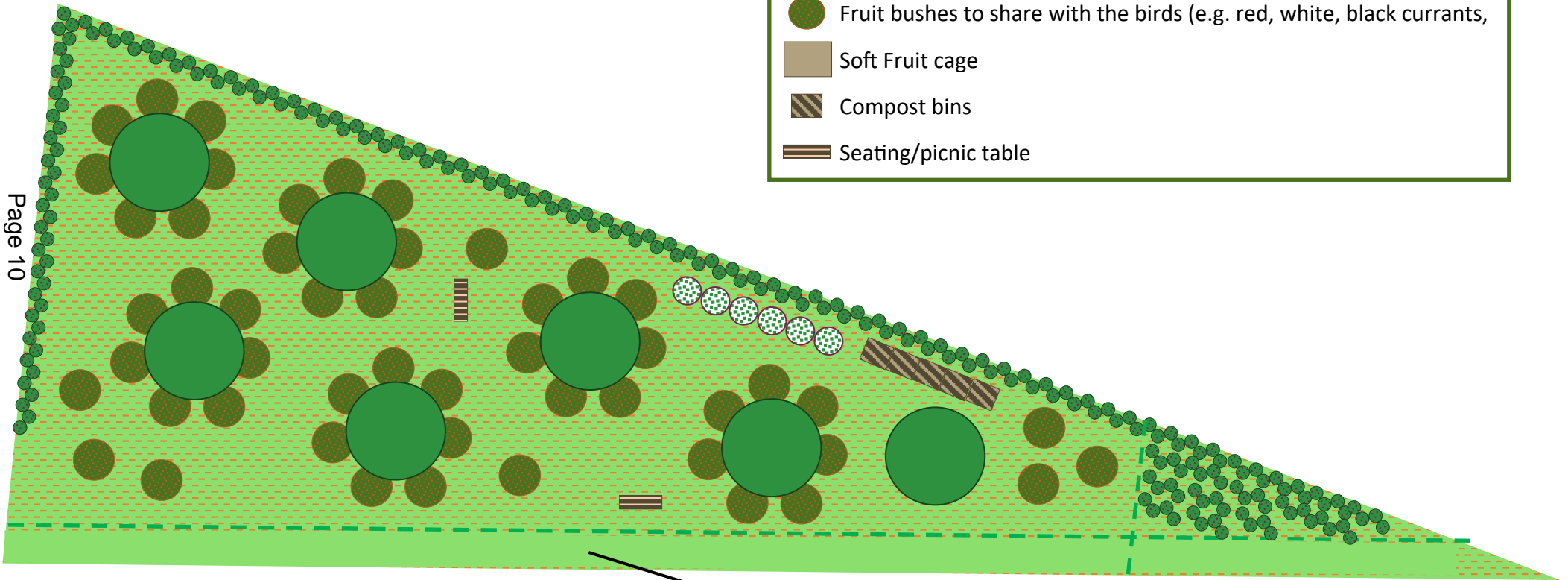

Page 10

Scale—5cm : 10m

1.5m wide mown strip to enable residents access to fences